



NEIGHBOURPLAN

Jackson Park-Brookdale Design Workshop Recap

A key feature of the NeighbourPLAN program is to host a design workshop, or charette, where built environment professionals are invited to work with residents to develop design solutions for priority locations in the neighbourhood. The idea is to create space to combine two important knowledge sets: expertise grown by living in the neighbourhood, brought by the residents, and technical planning expertise, brought by professionals.

The design workshop for the Jackson Park-Brookdale Neighbourhood was held on July 26, 2018. We had a full day of activities, which included:

- A walking tour of the neighbourhood
- Lunch and presentations
- Design work on the key priority areas

The 40 participants who were able to attend did a lot of fantastic work. Scroll through the pictures to get a sense of what was accomplished!

We are excited to share the results of the design workshop at the Neighbourhood Vision Shareback event, on **Tuesday October 16, 2018** at Highland Heights Public School.

Mark your calendars!





HIGHLAND RD. & FAIRBAIRN ST.



DOMINION PARK & BROOKDALE CRES.

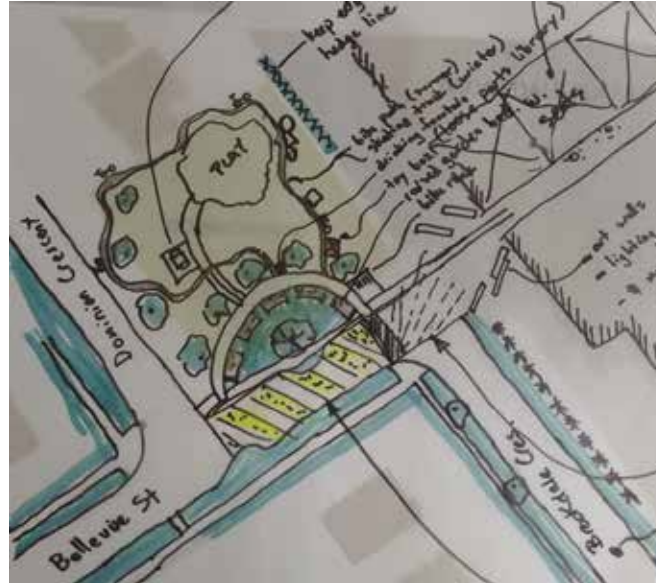

CHESTERFIELD AVE. & DOWNIE ST.



WOLSELY ST. & DONEGAL ST.

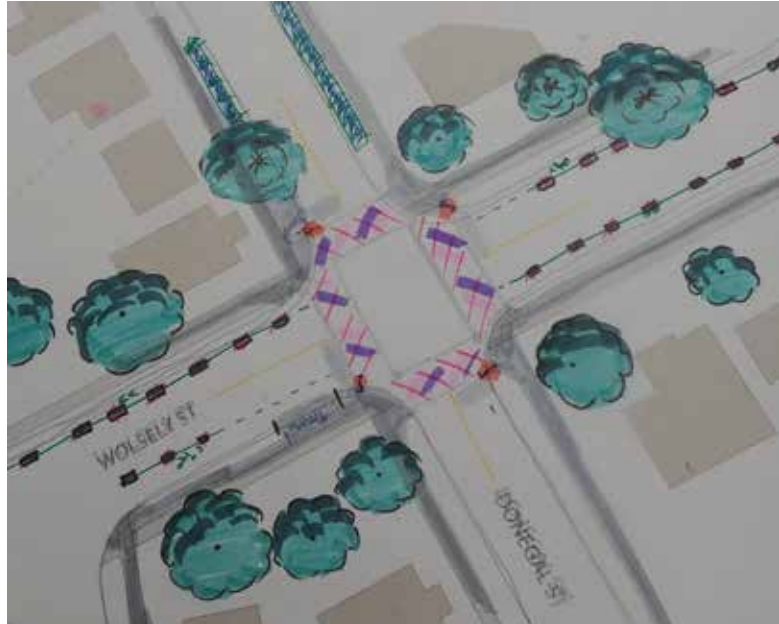

WOLSELY ST. & CHESTERFIELD AVE.



PARKHILL RD. & DOWNIE ST.

